

FLIP COVER CHANGEABLE INSERTS

Marketing material is easily kept current via changeable inserts held in place by magnetic flip cover. Units are permanently branded and allow end user to change messaging with printed inserts. Flip cover products are used daily giving your brand continual exposure. Print your own inserts with any color printer. Great for restaurants, bars, banks, hotels, schools, dealerships and retail.



Flip Cover Compact Counter Stand (MLCS1014)

Designed to be displayed on a countertop or table. Flip cover accept standard 8.5" x 11" paper insert (not included). Constructed of 1/8" thick aluminum composite. Unit stands upright with a stainless steel post. Post detaches to ship flat.

Product Dimensions: 10" x 14" | Image Area: 9.75" x 13.75" | Sides: 1 | Full Color | Set-up: \$195
Shipping Box: 19" x 11.5" x 2" | Shipping Weight: 1.7 lbs.

Item	25+	50+	100+	250+	500+
MLCS1014	36.03	30.46	26.85	24.65	23.02

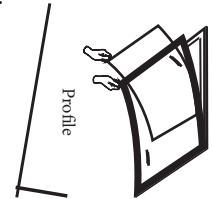

FRAMED ILLUMINATED SIGNS

By highlighting high resolution graphics, illuminated products draw attention to your brand. Cost effective and long life LED illumination. Includes full color high resolution imprint.



Snap Frame Light Box (SLB2620)

High resolution insert is backlit, drawing attention to menu/messaging. Front-loading inserts can be quickly changed by snapping open/closed the aluminum frame. Includes one full color translucent film insert (23.4" x 16.5"). Additional inserts are available at \$8.00/ea. Includes UL listed wall adapter that is 8 ft. long with on/off switch. Ready to hang.

Product Dimensions: 26.375" x 19.625" x 1.125" | Image Area: 23.4" x 16.5" | Sides: 1 | Full Color
Set-up: \$85 | Shipping Box: 28" x 24" x 4" | Shipping Weight: 6.5 lbs.

Item	25+	50+	100+	250+	500+
SLB2620	169.34	144.74	128.46	118.69	110.81

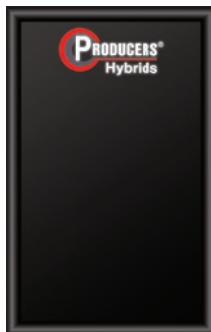

Backlit Illuminated Chalkboard 14" x 22" (CB1422i)

Solid maple wood frame available in black, red mahogany, medium brown or light autumn. High resolution graphics are backlit. LED illumination is powered by UL listed power supply with integrated on/off switch.

Product Dimensions: 22" x 14" x 3.5" | Image area: 20.5" x 12.5" | Sides: 1 | Full Color
Set-up: \$195 | Shipping Box: 24.5" x 15.75" x 4.25" | Shipping Weight: 8 lbs.

Item	25+	50+	100+	250+	500+
CB1422i	116.53	106.69	98.50	94.53	91.60

WOODEN CHALKBOARD KEY CADDY

Permanently branded key holder with the ability to update message. Holds up to 6 keys. Features compartment to hold mail, magazines, documents, etc. Full color imprint. Chalk included.



Key Caddy Chalkboard 12" x 16" (KEY1216CB)

Direct printed .5" thick manufactured wood.

Product Dimensions: 12" x 16" x 3" | Image Area: 12" x 5" | Sides: 1 | Full Color | Set-up: \$195
Shipping Box: 20.8" x 14.5" x 5" | Shipping Weight: 3 lbs.

Item	25+	50+	100+	250+	500+
KEY1216CB	59.20	49.54	43.82	40.66	39.26

SIGNS

SPECIALTIES

CLOCKS

MIRRORS

WOOD FRAME CLOCKS

ILLUMINATED CLOCKS